

ISO A1 594mm x 841mm
 Approved: VC
 Checked: IB
 Designer: JH
 Project Management Initials: GWM
 Last saved by: DANIEL KAYE (2021-11-19) Last Plotted: 2021-11-22
 Filename: L:\DCS\PROJECTS\C160664880_HIRAEI_BAY_FAS1900_CAD_GIS1910_CADD20 SHEETS\OUTLINE DESIGN\FOR PLANNING\6066-ACM-XX-XX-DR-C-0201_GLANDWR ROAD DESIGN OVERVIEW PLAN FOR PLANNING.DWG

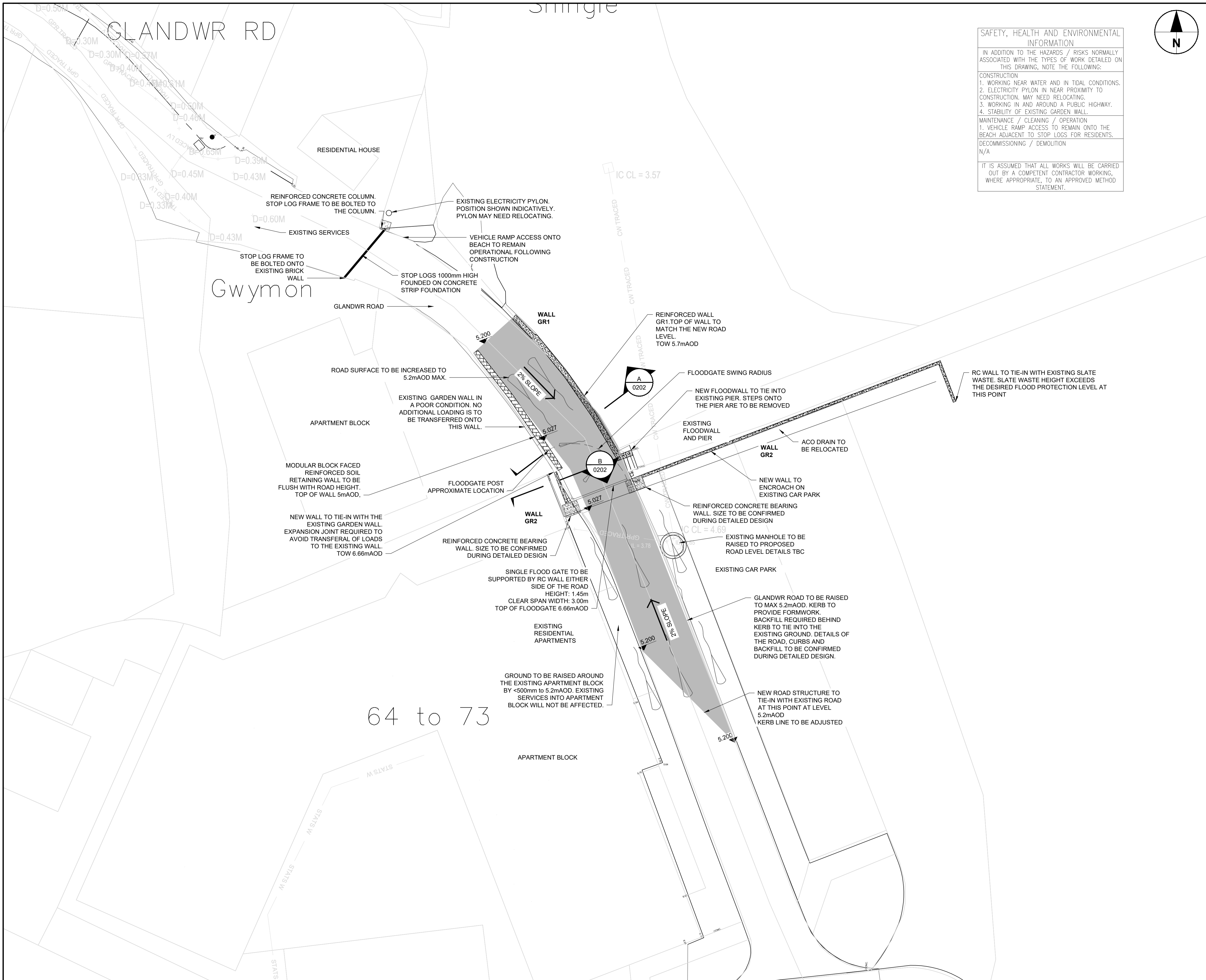

SAFETY, HEALTH AND ENVIRONMENTAL INFORMATION

IN ADDITION TO THE HAZARDS / RISKS NORMALLY ASSOCIATED WITH THE TYPES OF WORK DETAILED ON THIS DRAWING, NOTE THE FOLLOWING:

CONSTRUCTION

1. WORKING NEAR WATER AND IN TIDAL CONDITIONS.
2. ELECTRICITY PYLON IN NEAR PROXIMITY TO CONSTRUCTION. MAY NEED RELOCATING.
3. WORKING IN AND AROUND A PUBLIC HIGHWAY.
4. STABILITY OF EXISTING GARDEN WALL.

MAINTENANCE / CLEANING / OPERATION

1. VEHICLE RAMP ACCESS TO REMAIN ONTO THE BEACH ADJACENT TO STOP LOGS FOR RESIDENTS.

DECOMMISSIONING / DEMOLITION

N/A

IT IS ASSUMED THAT ALL WORKS WILL BE CARRIED OUT BY A COMPETENT CONTRACTOR WORKING, WHERE APPROPRIATE, TO AN APPROVED METHOD STATEMENT.

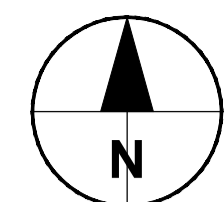

AECOM

PROJECT

HIRAEI BAY FLOOD ALLEVIATION SCHEME

CLIENT

CYGNOR GWYNEDD COUNCIL
 Council Offices, Shirehall Street, Caernarfon LL55 1SH

CONSULTANT

AECOM
 2 City Walk,
 Leeds, LS11 9AR
 +44(0)-113-301-8400 tel.
 www.aecom.com

1. DO NOT SCALE FROM THIS DRAWING.
2. ALL DIMENSIONS ARE IN M UNLESS OTHERWISE SPECIFIED. ALL ELEVATIONS ARE IN MAOD.
3. THIS DRAWING CONTAINS ORDNANCE SURVEY DATA @ CROWN COPYRIGHT AND DATABASE RIGHTS 2020 ORDNANCE SURVEY. ALL RIGHTS RESERVED.
4. INFORMATION IS RELIANT ON DATA FROM TOPOGRAPHIC SURVEYS CARRIED OUT IN 2020.
5. SERVICE INFORMATION IS BASED ON A C2 STAT SEARCH UNDERTAKEN IN FEBRUARY 2020. INFORMATION CONCERNING THE LOCATION OF THE UTILITIES APPARATUS IS PROVIDED AS A GENERAL GUIDE ONLY AND NO WARRANTY AS TO THEIR CORRECTNESS IS GIVEN OR IMPLIED. THE DRAWINGS SHOULD NOT BE RELIED UPON IN THE EVENT OF EXCAVATION OR OTHER WORKS MADE NEAR TO THE APPARATUS. APPARATUS MAY VARY IN DEPTH AND DEVIATE FROM THE MARKED ROUTE. A LINE ON A PLAN MAY INDICATE THE PRESENCE OF MORE THAN ONE CABLE, DUCT OR PIPE. GPR SURVEYS AND UPDATED SERVICES SEARCHES SHOULD BE UNDERTAKEN PRIOR TO THE COMMENCEMENT OF ANY CONSTRUCTION WORKS.
6. THE DESIGN LEVELS SHOWN IN THIS DRAWING ARE BASED ON THE HIRAEI BAY OBC OVERTOPPING AND FLOOD MODELING TECHNICAL NOTE APPENDIX B. A FREEBOARD ALLOWANCE ABOVE DESIGN WATER LEVEL OF 300MM IS INCLUDED FOR WALLS AND SHEET PILE.
7. THE INFORMATION CONTAINED IN THIS DRAWING IS FOR CONSULTATION/DESIGN/COSTING PURPOSES ONLY AND IS NOT TO BE USED FOR CONSTRUCTION.
8. DESIGN CONFIGURATION TO BE CONFIRMED SUBJECT TO FURTHER GROUND INVESTIGATION DATA.
9. THESE ARRANGEMENTS ARE NOT FINAL AND SHOULD BE CONFIRMED DURING DETAILED DESIGN.
10. STRUCTURAL AND DRAINAGE DESIGN TO BE CONFIRMED DURING DETAILED DESIGN.
11. FOR TYPICAL SECTIONS REFER TO DRAWING 60664880-ACM-XX-XX-DR-C-0202.

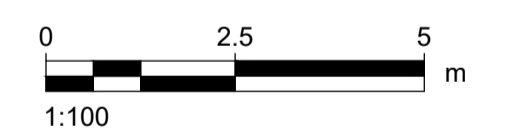

FOR INFORMATION ONLY

ISSUE/REVISION

NO	DATE	DESCRIPTION
P01	12/11/2021	FIRST REVISION
I/R	DATE	DESCRIPTION

PROJECT NUMBER

60664880

SHEET TITLE

GLANDWR ROAD DESIGN OVERVIEW PLAN FOR PLANNING

SHEET NUMBER

60664880-ACM-XX-XX-DR-C-0201

This drawing has been prepared for the use of AECOM's client. It may not be used, modified, reproduced or relied upon by third parties, except as agreed by AECOM or as required by law. AECOM accepts no responsibility, and denies any liability whatsoever, to any party that uses or relies on this drawing without AECOM's express written consent. All measurements must be obtained from the stated dimensions.